

An aerial photograph of a large, historic stone and timber house with a large lawn and a river. The house features a prominent gabled roof with dormer windows and a mix of stone and timber cladding. A large, well-maintained lawn is in the foreground, bordered by a stone wall and a river. The background is filled with lush green trees and a rolling landscape under a blue sky with scattered clouds.

Howard Morley  
& Sons

PER MONTH

**£9,000 Per Month**

**Mill Lane**

Godalming, GU8 5AH

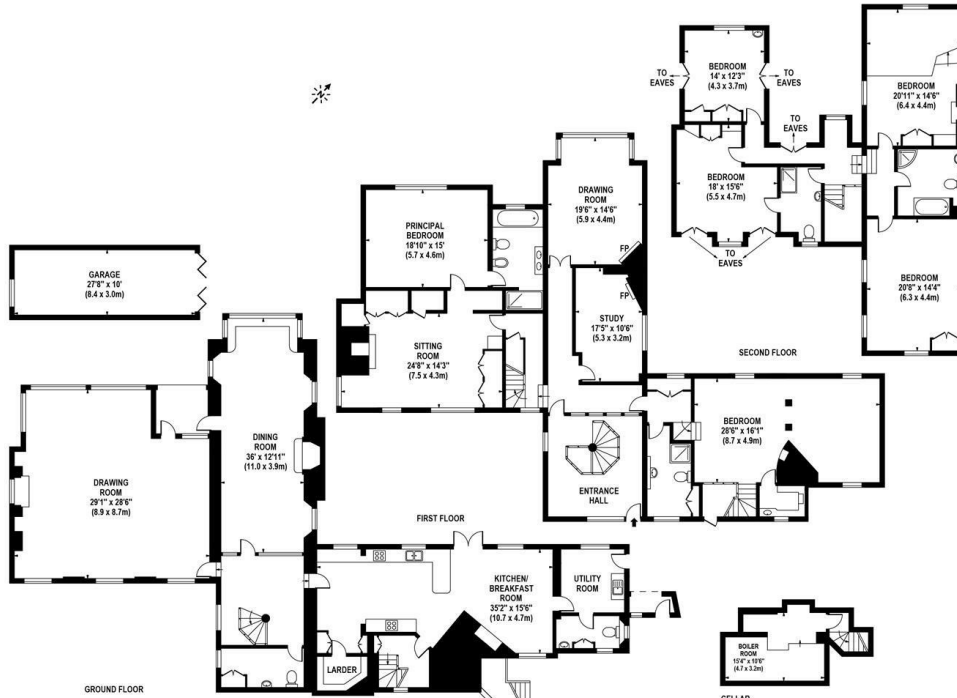

6

4

5

Energy Efficiency Rating		Current	Potential
Very energy efficient - lower running costs			
(92 plus)	A		
(81-91)	B		
(69-80)	C		73
(55-68)	D		
(39-54)	E	40	
(21-38)	F		
(1-20)	G		
Not energy efficient - higher running costs			
England & Wales		EU Directive 2002/91/EC	

Agents Note: Whilst every care has been taken to prepare these particulars, they are for guidance purposes only. All measurements are approximate and are for general guidance purposes only and whilst every care has been taken to ensure their accuracy, they should not be relied upon and potential buyers/tenants are advised to recheck the measurements

**Howard Morley & Sons**

**OFFICE ADDRESS**  
276 High Street  
Guildford  
Surrey  
GU1 3JL

**OFFICE DETAILS**  
01483 575 304  
lettings@hmorley.co.uk  
hmorley.co.uk